

SCHMATIC



SPECIFICATIONS

FUNCTION:  
1P2T ON-OFF-ON

RATING:  
15A @125VAC [cURus]  
16(4)A @250VAC T125/55 [ENEC]

CONTACT RESISTANCE:  
Initial: 20mΩ Max. at 1A 5VDC

INSULATION RESISTANCE:  
100MΩ Min. at 500VDC

DIELECTRIC STRENGTH:  
1,000VAC for 1 Minute

ELECTRICAL LIFE:  
6,000 Cycles [UR, cUR]  
10,000 Cycles [VDE]

TEMPERATURE:  
-20°C to 65°C [cURus]  
-20°C to 105°C [cURus]  
0°C to 85°C [ENEC, VDE]  
0°C to 125°C [ENEC, VDE]

APPROVALS:

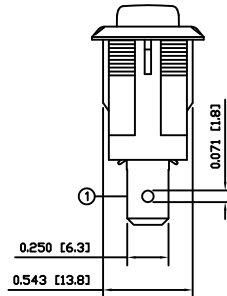
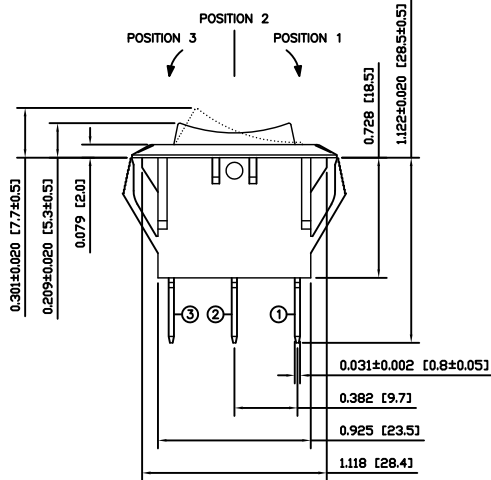
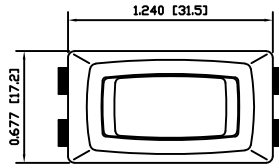

COLORS AND MARKINGS

BODY:  
Black

ACTUATOR:  
Black

MARKINGS:  
None

MARKING COLOR:  
None

MATERIALS

BODY:  
Polyamide 6/6 (PA66), UL94 V-2

ACTUATOR:  
Polyamide 6/6 (PA66), UL94 V-2

SPRING:  
Steel

CONTACTS:  
Silver Clad Copper

TERMINALS:  
Silver Plated Copper  
Silver Plated Brass

SUGGESTED PANEL CUTOUT

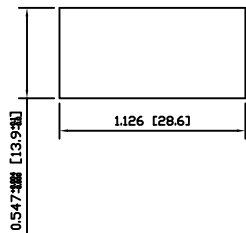

REV.	DESCRIPTION	DATE	BY	CHKD.
D	REMOVED RATING 20A @125VAC 3/4HP T105 [cURus]	23370	05/17/18	MJR
C	UPDATED RATINGS	23175	01/19/18	MJR
B	CORRECTED RATING	20048	07/05/11	CAB
A	INITIAL RELEASE	19336	11/04/10	CAB
REV.	DESCRIPTION	DATE	BY	CHKD.

DIMENSIONS	
INCHES [MILLIMETERS]	
GENERAL TOLERANCES	
±0.008 [±0.2] / ±1'	
SCALE	PROJECTION
DRAWING NOT TO SCALE	1st Angle

RSC145C1100			
ITEM NUMBER	DATE	REVISION	
38-RSC145C1100	JULY 5, 2011	D	

THE INFORMATION CONTAINED IN THIS DOCUMENT IS PROPRIETARY TO E-SWITCH AND IS NOT TO BE COPIED OR TRANSFERRED